

WOLONG
Power your future



Reciprocating Compressor MV Motors

WP11, TEAAC
3 Phase, 60 Hz
4160-6600V, 800-5000 HP



Solidly Built Motors

Engineered to Last

GE motors from Wolong are manufactured in North America. They are known for high mechanical integrity and superior electrical designs, reliably and efficiently operate in hundreds of petroleum and chemical facilities around the world.

Reciprocating compressors experience high-cyclic loads. Their performance and reliability rely on a robust, severe-duty compressor train. It is important to choose the right electric motor to help control any fluctuations and torque oscillations to minimize fatigue and increase the reliability of the compressor.

To best meet these application challenges, our motors have these key features:

- High strength AISI 4140 steel to handle current pulsations and torsional vibration
- Oversized shaft diameters matched to compressor shafts for optimal coupling and reliable operation
- Torsional and current pulsation data available
- Keyless shaft extension
- Optimized frame design for low noise and vibration
- Durable, moisture resistant insulation system excels in VFD applications meeting and exceeding NEMA MG1-31 standards.



GE motors from Wolong are engineered, tested, and proven to meet or exceed all applicable NEMA, CSA, and UL requirements and standards for reciprocating compressor applications.



Features

Type	AC Induction
Phase	3
Frequency	60 Hz
Voltage	4160 - 6600 V
Power	800 to 5000 HP
Speed	1200 and 900 RPM
Enclosure	WPII (TEAAC available)
Efficiency	Premium Efficiency
Insulation	Class F Custom Polyseal System
Ambient	50°C
S.F. Factor	1.15 (continuous)
Temp Rise	Class-B @ 1.0 service factor

VFD	Inverter Duty - 2:1 speed range in constant torque operation
Brg Type	Anti-friction ball (sleeve available)
Shaft	AISI 4140 steel
Haz. Areas	Class I Division 2
Coils	Form wound
RTD's	100-Ohm Platinum wired to an accessory box: Stator Winding RTD - 2 per phase Bearing RTD - 1 per bearing
Space Htr.	Frame mounted for safe operation in Div 2 environment
Hardware	Corrosion-resistant

▼ Ratings and Dimensions

Anti-Friction Bearings

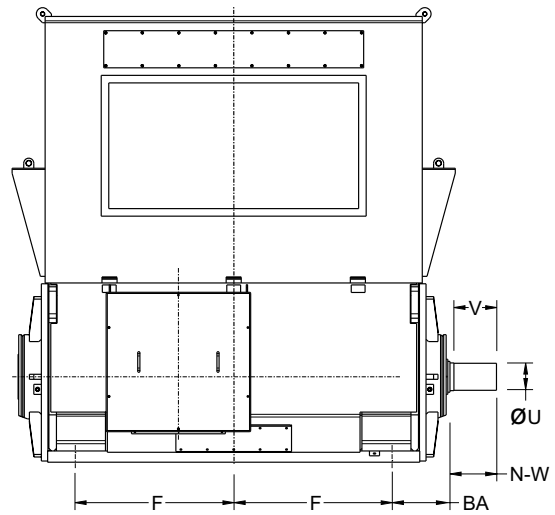
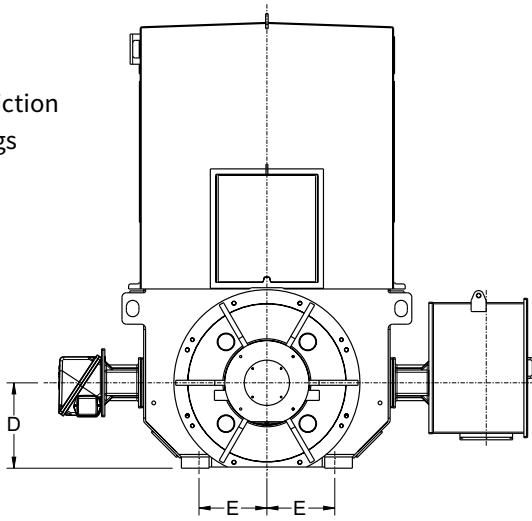

Sleeve Bearings

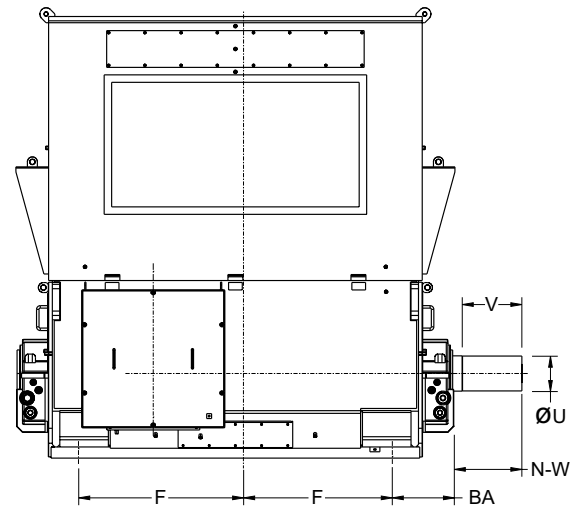
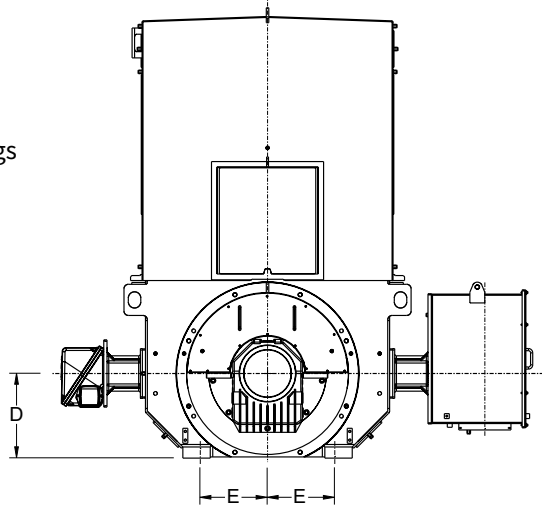

HP	Speed (RPM)	Enclosure	Frame	ØU Dia. (in)	2F (in)	2E (in)	D (in)	BA+N-W (in)
800	1200	WP11	5810	5.0	36.0	23.0	14.5	18.00
800	900	WP11	5812	5.0	45.0	23.0	14.5	18.00
1000	1200	WP11	5812	5.0	45.0	23.0	14.5	18.00
1000	900	WP11	5812	5.0	45.0	23.0	14.5	18.00
1500	1200	WP11	6811	6.0	50.0	27.0	17.0	21.25
1500	900	WP11	6811	6.0	50.0	27.0	17.0	21.25
2000	1200	WP11	6813	6.5	63.0	27.0	17.0	21.25
2000	900	WP11	8011	6.5	56.0	34.0	20.0	26.25
2500	1200	WP11	6813	7.5	63.0	27.0	17.0	21.25
2500	900	WP11	9611	7.5	63.0	43.0	24.0	28.75
3500	1200	WP11	8012	7.5	70.0	34.0	20.0	26.25
3500	900	WP11	9612	7.5	71.0	43.0	24.0	28.75
5000	1200	WP11	12011	8.5	71.0	54.0	30.0	30.75
5000	900	WP11	12012	8.5	80.0	54.0	30.0	30.25

WOLONG

Power your future



www.wolongamerica.com

GE is a trademark of General Electric Company. Manufactured under trademark license.
©2023, Wolong Electric America LLC. All rights reserved
NEMA Premium is a trademark of NEMA.
GEA33480-EN (9/2023)